

## mPML

### Pompy liniowe standardowe dla wody pitnej



#### PRZEZNACZENIE

Pompy liniowe standardowe mPML przeznaczone są do pompowania wody pitnej.

#### ZASTOSOWANIE

Pompy liniowe standardowe stosowane w instalacjach ciepłowniczych i grzewczych, w systemach chłodniczych, w instalacjach zaopatrzenia w wodę, procesach technologicznych, w chłodnictwie przemysłowym itp.

#### ZAKRES UŻYTKOWANIA

|                      |                          |
|----------------------|--------------------------|
| Wydajność            | do 180 m <sup>3</sup> /h |
| Wysokość podnoszenia | do 50 m                  |
| Ciśnienie robocze    | 1,0 MPa                  |
| Średnica przyłączy   | DN40-DN100               |
| Moc silnika          | do 22 kW                 |
| Temperatura czynnika | 0 do 90°C                |

#### CECHY KONSTRUKCYJNE

##### część hydrauliczna

- pompa pionowa jednostopniowa z suchym wirnikiem silnika,
  - korpus, wirnik i pokrywa wykonana z brązu,
  - monoblok-wirnik pompy montowany bezpośrednio na wale silnika,
  - konstrukcja in-line,
  - uszczelnienie mechaniczne - standardowo DMC,
- ##### silnik
- opcjonalnie jedno lub trójfazowy asynchroniczny,
  - całkowicie zamknięty chłodzony powietrzem,
  - wał silnika przedłużony,
  - obroty 1400 lub 2900 min<sup>-1</sup>,
  - stopień ochrony IP54 lub IP55,
  - klasa izolacji F,
  - wymagane pełne zewnętrzne zabezpieczenie elektryczne.

#### KLUCZ OZNACZEŃ

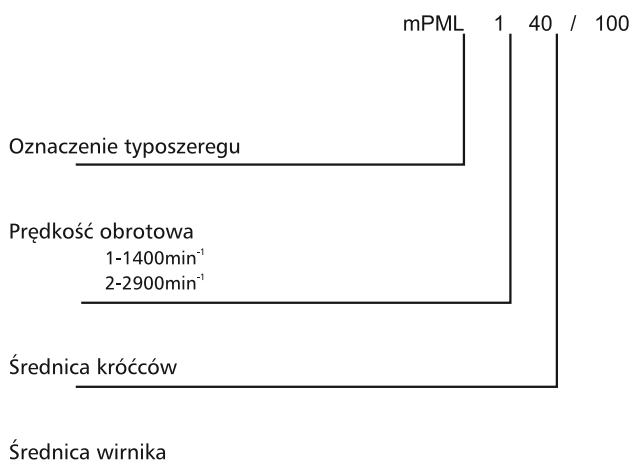

#### ZALETY

- niskie koszty montażu,
- dobra relacja cena/jakość,
- możliwość współpracy z przetwornicą częstotliwościową,
- łatwość instalacji i obsługi,
- niskie zużycie energii,
- wysoka sprawność silników,
- atest PZH,
- podwyższony komfort i jakość wykonania.

**BUDOWA**

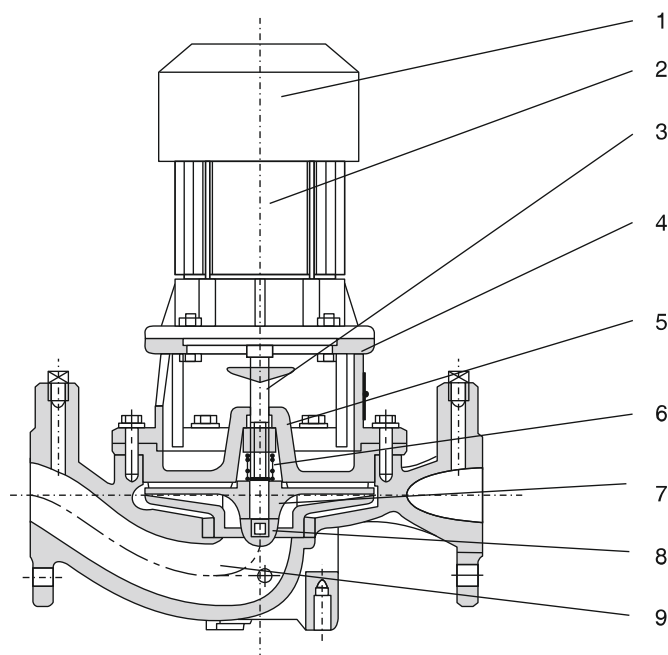

- 1. Silnik pompy
- 2. Puszka zaciskowa
- 3. Wał pompy
- 4. Łącznik
- 5. Pokrywa
- 6. Dławnica
- 7. Wirnik pompy
- 8. Nakrętka wirnika
- 9. Korpus pompy

**Uszczelnienie**

Standardowo w pompach montowane są dławnice DMc, jednak na specjalne zamówienie lub wyniku specyfikacji tłocznej cieczy montowane są również innego typu uszczelnienia.

Przykładowy rysunek przekrojowy dławnicy typu DMc

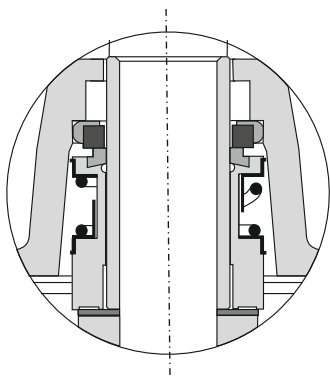

| Typ dławnicy | Elementy obrotowe | Elementy stałe | Uszczelnienie wtórne |
|--------------|-------------------|----------------|----------------------|
| DMc          | C                 | SIC            | EPDM                 |
| DMcA         | C                 | SIC            | VITON                |
| DMcB         | SIC               | SIC            | VITON                |
| DMcC         | SIC               | SIC            | EPDM                 |

Oznaczenia materiałów dławnicy:  
 C - grafit impregnowany żywicą  
 SIC - węgiel krzemowy  
 EPDM - kauczuk etylo-propylenowy  
 VITON - kauczuk fluorowy

### POMPY LINIOWE

#### CHARAKTERYSTYKA

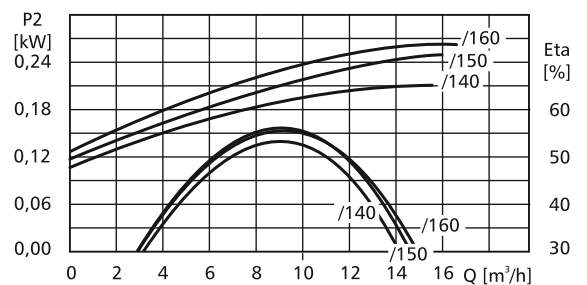
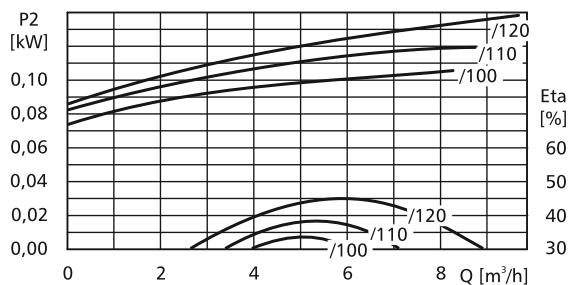
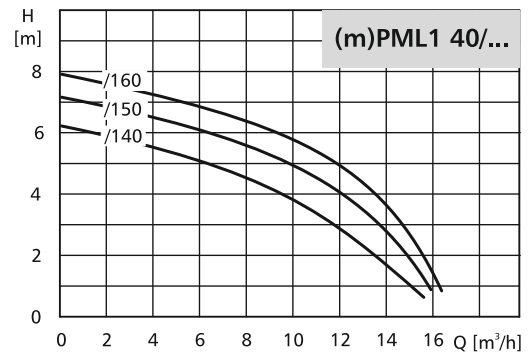
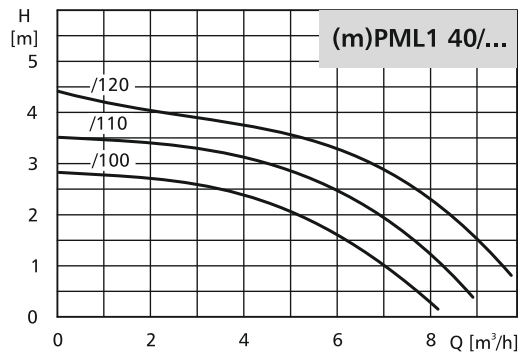

#### DANE MONTAŻOWE

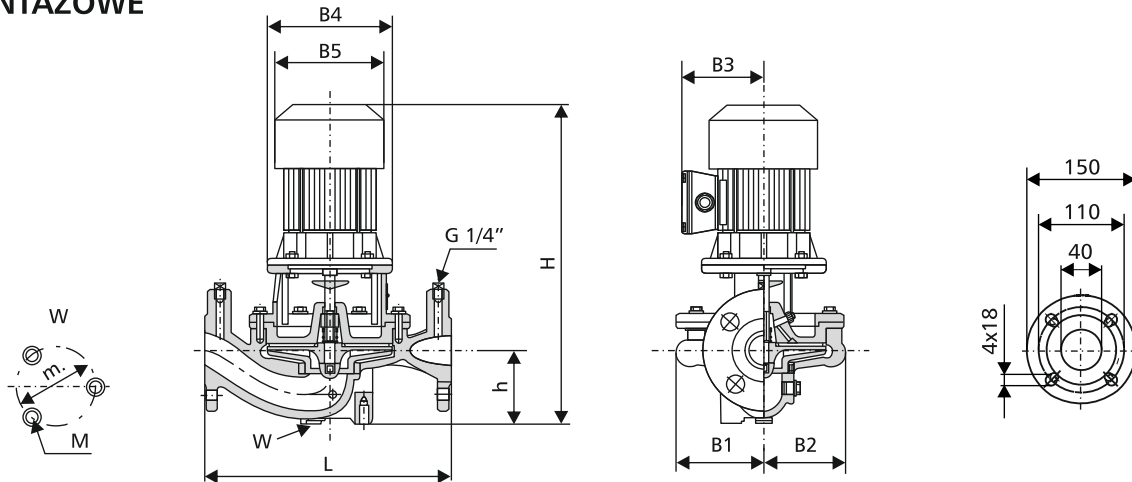

| TYP POMPY      | Moc silnika | Wymiary [mm] |     |    |     |     |     |     |     |    |       | Masa [kg] |     |
|----------------|-------------|--------------|-----|----|-----|-----|-----|-----|-----|----|-------|-----------|-----|
|                |             | L            | H   | h  | B1  | B2  | B3  | B4  | B5  | m  | M     | mPML      | PML |
| (m)PML1 40/100 | 0,12        | 250          | 344 | 80 | 81  | 79  | 103 | 140 | 120 | 90 | 3xM10 | 13        | 12  |
| (m)PML1 40/110 | 0,12        | 250          | 344 | 80 | 81  | 79  | 103 | 140 | 120 | 90 | 3xM10 | 13        | 12  |
| (m)PML1 40/120 | 0,18        | 250          | 356 | 80 | 81  | 79  | 103 | 140 | 120 | 90 | 3xM10 | 15        | 14  |
| (m)PML1 40/140 | 0,25        | 320          | 397 | 90 | 100 | 100 | 107 | 160 | 141 | 90 | 3xM10 | 21        | 19  |
| (m)PML1 40/150 | 0,25        | 320          | 397 | 90 | 100 | 100 | 107 | 160 | 141 | 90 | 3xM10 | 21        | 19  |
| (m)PML1 40/160 | 0,37        | 320          | 406 | 90 | 100 | 100 | 107 | 160 | 141 | 90 | 3xM10 | 23        | 21  |

#### DANE ELEKTRYCZNE

| Moc silnika [kW] | Wielkość węża | U [V]             | n [min <sup>-1</sup> ] | $\eta$ [%] | cos $\varphi$ | I <sub>n</sub> [A] | I <sub>n</sub> /I <sub>r</sub> [A] |
|------------------|---------------|-------------------|------------------------|------------|---------------|--------------------|------------------------------------|
| 0,12             | W0            | 3~230-240/400-415 | 1400                   | 64         | 0,72          | 0,70/0,40          | 3,2                                |
| 0,18             | W0            | 3~230-240/400-415 | 1400                   | 64         | 0,70          | 1,10/0,65          | 3,2                                |
| 0,25             | W1            | 3~230-240/400-415 | 1400                   | 66         | 0,68          | 1,50/0,85          | 3,0                                |
| 0,37             | W1            | 3~230-240/400-415 | 1400                   | 68         | 0,72          | 2,10/1,20          | 3,1                                |

CHARAKTERYSTYKA

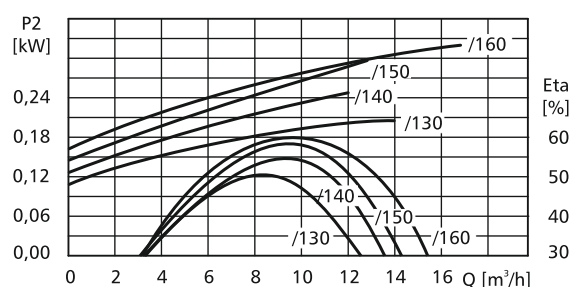
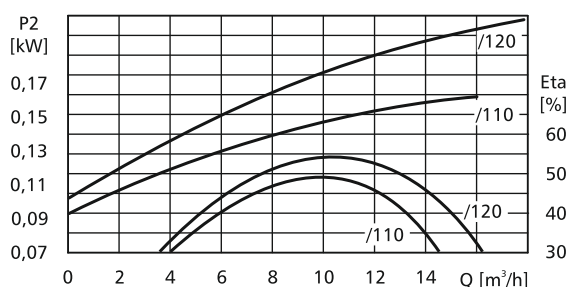
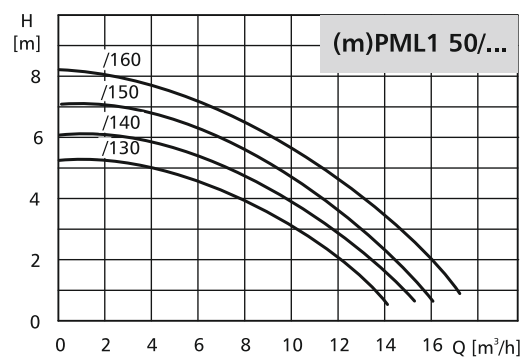
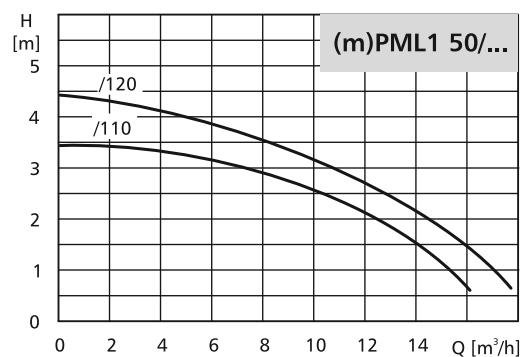

DANE MONTAŻOWE

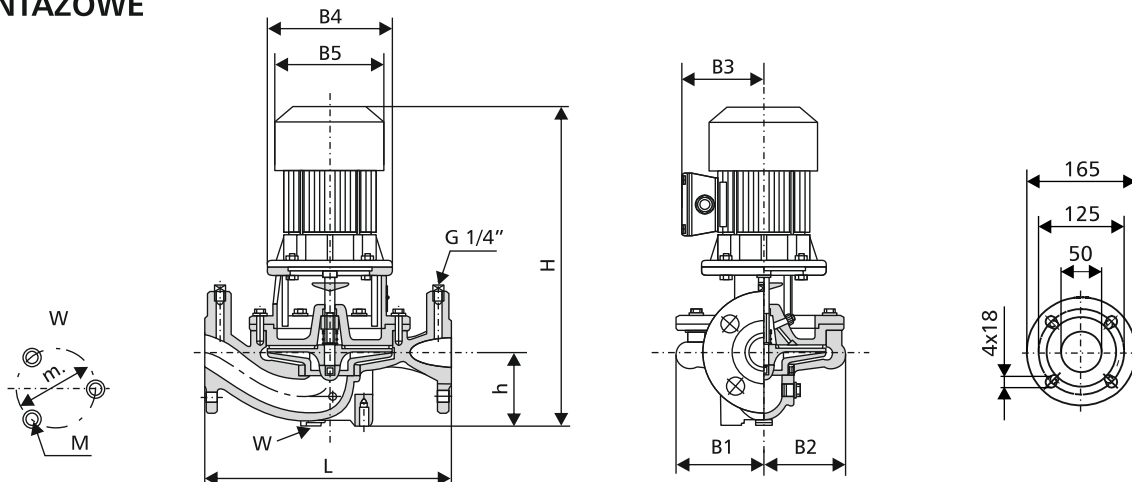

| TYP POMPY      | Moc silnika | Wymiary [mm] |     |     |    |    |     |     |     |    |       | Masa [kg] |     |
|----------------|-------------|--------------|-----|-----|----|----|-----|-----|-----|----|-------|-----------|-----|
|                |             | L            | H   | h   | B1 | B2 | B3  | B4  | B5  | m  | M     | mPML      | PML |
| (m)PML1 50/110 | 0,18        | 280          | 375 | 95  | 92 | 92 | 103 | 140 | 120 | 90 | 3xM10 | 23        | 21  |
| (m)PML1 50/120 | 0,18        | 280          | 375 | 95  | 92 | 92 | 103 | 140 | 120 | 90 | 3xM10 | 23        | 21  |
| (m)PML1 50/130 | 0,25        | 340          | 413 | 105 | 95 | 95 | 103 | 160 | 141 | 90 | 3xM10 | 32        | 29  |
| (m)PML1 50/140 | 0,25        | 340          | 413 | 105 | 95 | 95 | 107 | 160 | 141 | 90 | 3xM10 | 32        | 29  |
| (m)PML1 50/150 | 0,37        | 340          | 422 | 105 | 95 | 95 | 107 | 160 | 141 | 90 | 3xM10 | 32        | 30  |
| (m)PML1 50/160 | 0,37        | 340          | 422 | 105 | 95 | 95 | 107 | 160 | 141 | 90 | 3xM10 | 32        | 30  |

DANE ELEKTRYCZNE

| Moc silnika [kW] | Wielkość wałka | U [V]             | n [min <sup>-1</sup> ] | $\eta$ [%] | cos $\varphi$ | I <sub>n</sub> [A] | I <sub>n</sub> /I <sub>r</sub> [A] |
|------------------|----------------|-------------------|------------------------|------------|---------------|--------------------|------------------------------------|
| 0,18             | W0             | 3~230-240/400-415 | 1400                   | 64         | 0,70          | 1,10/0,65          | 3,2                                |
| 0,25             | W1             | 3~230-240/400-415 | 1400                   | 66         | 0,68          | 1,50/0,85          | 3,0                                |
| 0,37             | W1             | 3~230-240/400-415 | 1400                   | 68         | 0,72          | 2,10/1,20          | 3,1                                |

### POMPY LINIOWE

#### CHARAKTERYSTYKA

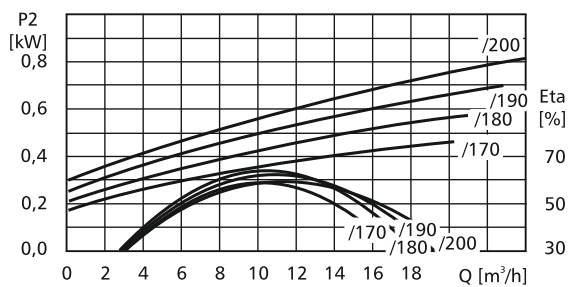
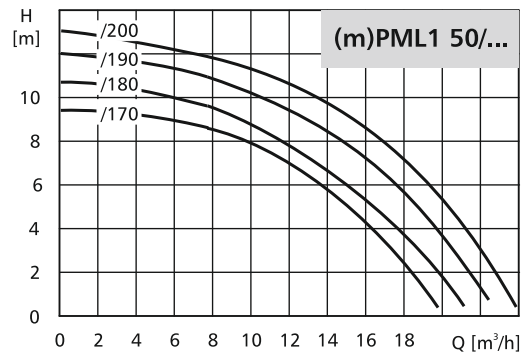

#### DANE MONTAŻOWE

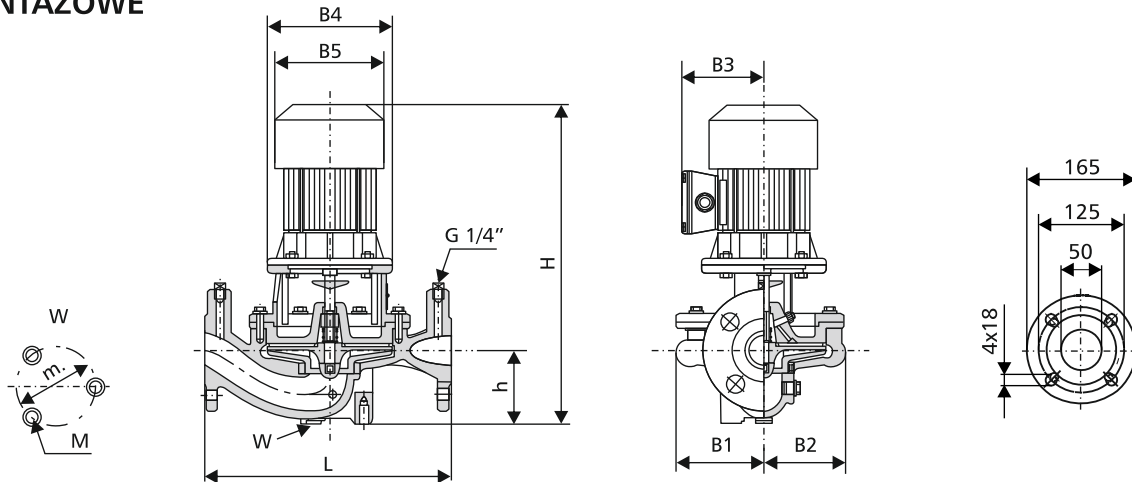

| TYP POMPY      | Moc silnika | Wymiary [mm] |     |     |     |     |     |     |     |     |       | Masa [kg] |     |
|----------------|-------------|--------------|-----|-----|-----|-----|-----|-----|-----|-----|-------|-----------|-----|
|                |             | L            | H   | h   | B1  | B2  | B3  | B4  | B5  | m   | M     | mPML      | PML |
| (m)PML1 50/170 | 0,55        | 400          | 422 | 110 | 112 | 112 | 115 | 160 | 157 | 140 | 3xM10 | 40        | 40  |
| (m)PML1 50/180 | 0,55        | 400          | 422 | 110 | 112 | 112 | 115 | 160 | 157 | 140 | 3xM10 | 37        | 34  |
| (m)PML1 50/190 | 0,75        | 400          | 470 | 110 | 112 | 112 | 120 | 160 | 160 | 140 | 3xM10 | 39        | 36  |
| (m)PML1 50/200 | 0,75        | 400          | 470 | 110 | 112 | 112 | 120 | 160 | 160 | 140 | 3xM10 | 40        | 36  |

#### DANE ELEKTRYCZNE

| Moc silnika [kW] | Wielkość wałka | U [V]             | n [min <sup>-1</sup> ] | η [%] | cos φ | In [A]    | In/Ir [A] |
|------------------|----------------|-------------------|------------------------|-------|-------|-----------|-----------|
| 0,55             | W2             | 3~230-240/400-415 | 1400                   | 70    | 0,68  | 2,95/1,70 | 3,6       |
| 0,75             | W2             | 3~230-240/400-415 | 1400                   | 80    | 0,65  | 3,70/2,20 | 4,2       |

CHARAKTERYSTYKA

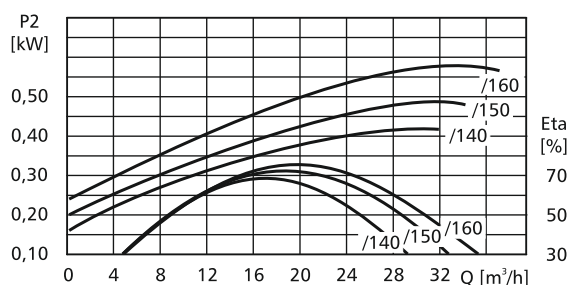
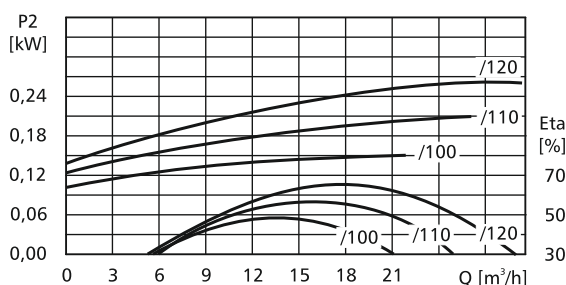
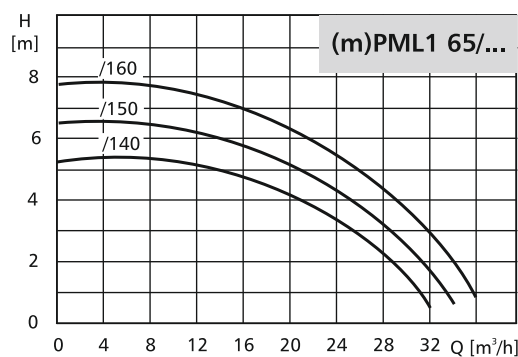
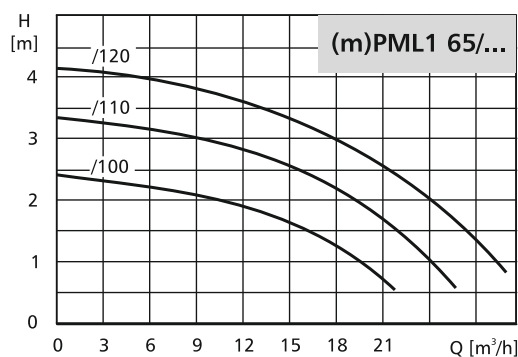

DANE MONTAŻOWE

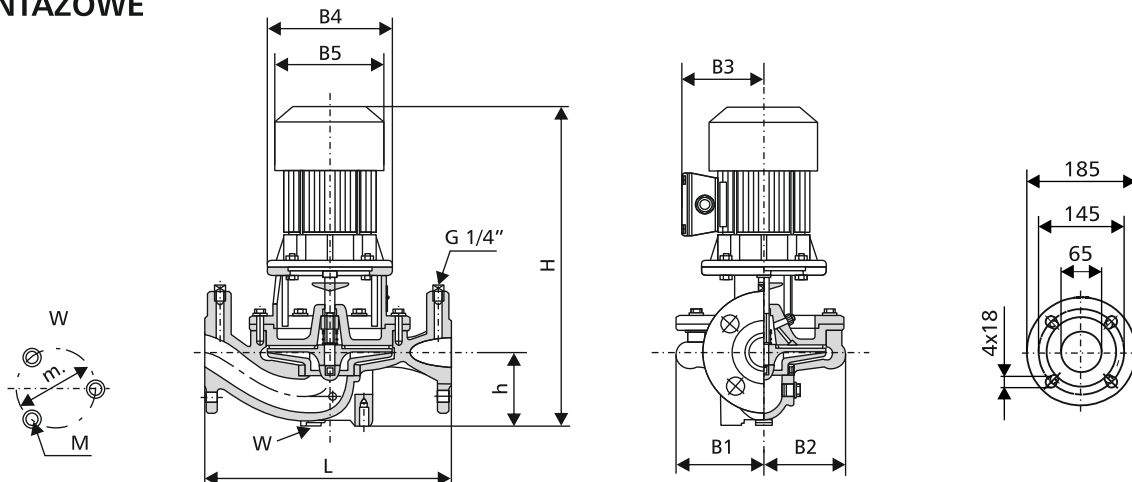

| TYP POMPY      | Moc silnika | Wymiary [mm] |     |     |     |     |     |     |     |    |       | Masa [kg] |     |
|----------------|-------------|--------------|-----|-----|-----|-----|-----|-----|-----|----|-------|-----------|-----|
|                |             | L            | H   | h   | B1  | B2  | B3  | B4  | B5  | m  | M     | mPML      | PML |
| (m)PML1 65/100 | 0,18        | 340          | 400 | 115 | 99  | 99  | 103 | 140 | 120 | 90 | 3xM10 | 25        | 23  |
| (m)PML1 65/110 | 0,25        | 340          | 431 | 115 | 99  | 99  | 107 | 160 | 141 | 90 | 3xM10 | 26        | 24  |
| (m)PML1 65/120 | 0,25        | 340          | 431 | 115 | 99  | 99  | 107 | 160 | 141 | 90 | 3xM10 | 26        | 24  |
| (m)PML1 65/140 | 0,55        | 400          | 456 | 120 | 117 | 117 | 115 | 160 | 157 | 90 | 3xM10 | 36        | 33  |
| (m)PML1 65/150 | 0,55        | 400          | 456 | 120 | 117 | 117 | 115 | 160 | 157 | 90 | 3xM10 | 39        | 35  |
| (m)PML1 65/160 | 0,75        | 400          | 484 | 120 | 117 | 117 | 115 | 160 | 157 | 90 | 3xM10 | 39        | 35  |

DANE ELEKTRYCZNE

| Moc silnika [kW] | Wielkość wałka | U [V]             | n [min <sup>-1</sup> ] | η [%] | cos φ | In [A]    | In/Ir [A] |
|------------------|----------------|-------------------|------------------------|-------|-------|-----------|-----------|
| 0,18             | W0             | 3~230-240/400-415 | 1400                   | 64    | 0,70  | 1,10/0,65 | 3,2       |
| 0,25             | W1             | 3~230-240/400-415 | 1400                   | 66    | 0,68  | 1,50/0,85 | 3,0       |
| 0,55             | W2             | 3~230-240/400-415 | 1400                   | 70    | 0,68  | 2,95/1,70 | 3,6       |
| 0,75             | W2             | 3~230-240/400-415 | 1400                   | 80    | 0,65  | 3,70/2,20 | 4,2       |

### POMPY LINIOWE

#### CHARAKTERYSTYKA

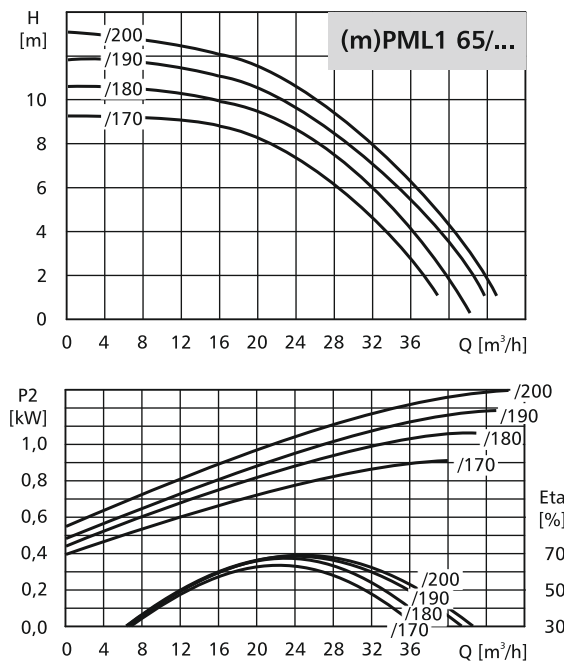

#### DANE MONTAŻOWE

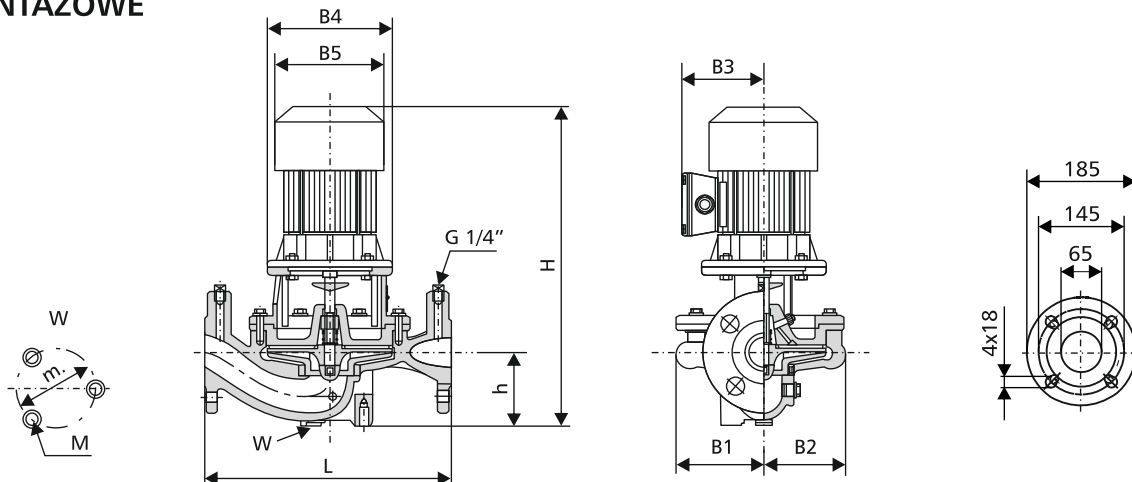

| TYP POMPY      | Moc silnika | Wymiary [mm] |     |     |     |     |     |     |     |     |       | Masa [kg] |     |
|----------------|-------------|--------------|-----|-----|-----|-----|-----|-----|-----|-----|-------|-----------|-----|
|                |             | L            | H   | h   | B1  | B2  | B3  | B4  | B5  | m   | M     | mPML      | PML |
| (m)PML1 65/170 | 1,1         | 400          | 437 | 110 | 139 | 126 | 120 | 160 | 180 | 140 | 3xM10 | 56        | 51  |
| (m)PML1 65/180 | 1,1         | 400          | 437 | 110 | 139 | 126 | 120 | 160 | 180 | 140 | 3xM10 | 56        | 51  |
| (m)PML1 65/190 | 1,1         | 400          | 437 | 110 | 139 | 126 | 120 | 160 | 180 | 140 | 3xM10 | 56        | 51  |
| (m)PML1 65/200 | 1,5         | 400          | 482 | 110 | 139 | 126 | 135 | 200 | 180 | 140 | 3xM10 | 58        | 53  |

#### DANE ELEKTRYCZNE

| Moc silnika [kW] | Wielkość wałka | U [V]             | n [min <sup>-1</sup> ] | η [%] | cos φ | In [A]    | In/Ir [A] |
|------------------|----------------|-------------------|------------------------|-------|-------|-----------|-----------|
| 1,1              | W3             | 3~230-240/400-415 | 1400                   | 81    | 0,76  | 4,50/2,60 | 5,7       |
| 1,5              | W3             | 3~230-240/400-415 | 1400                   | 83    | 0,76  | 6,00/3,40 | 6,0       |

CHARAKTERYSTYKA

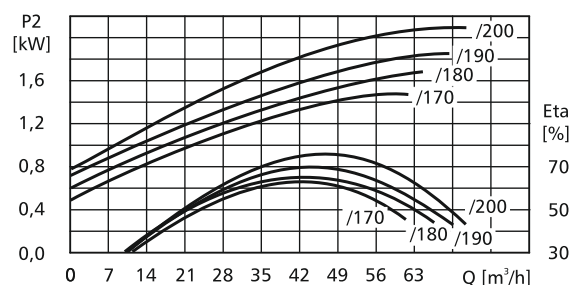
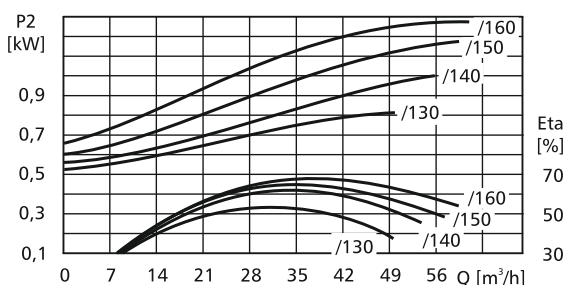
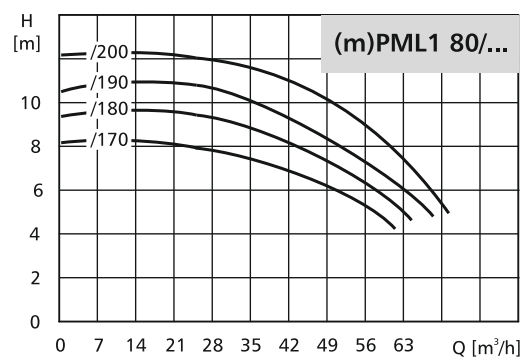
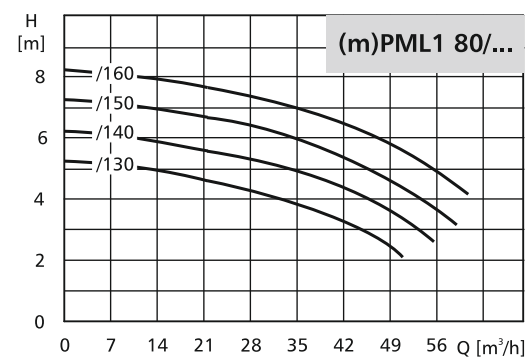

DANE MONTAŻOWE

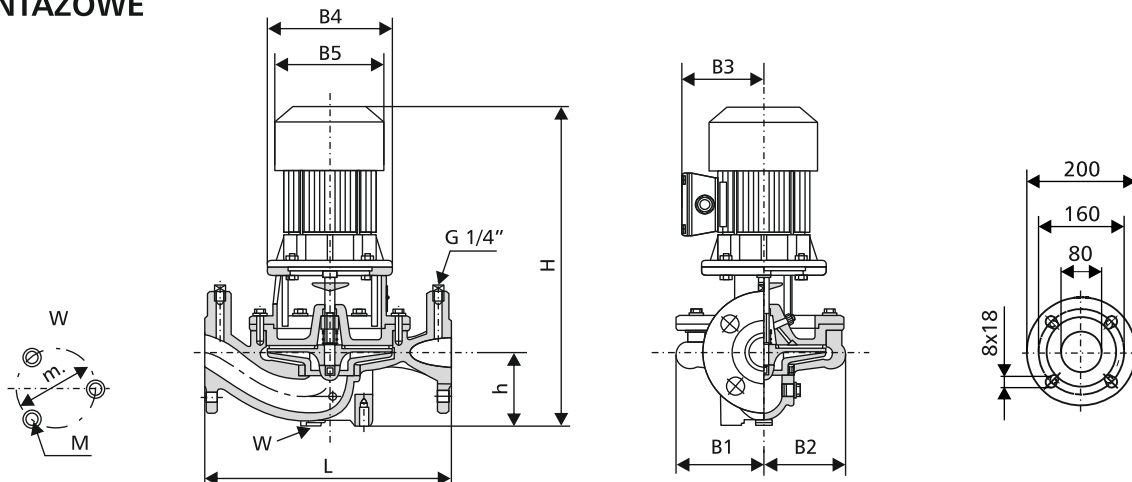

| TYP POMPY      | Moc silnika | Wymiary [mm] |     |     |     |     |     |     |     |     |       | Masa [kg] |     |
|----------------|-------------|--------------|-----|-----|-----|-----|-----|-----|-----|-----|-------|-----------|-----|
|                |             | L            | H   | h   | B1  | B2  | B3  | B4  | B5  | m   | M     | mPML      | PML |
| (m)PML1 80/130 | 0,75        | 450          | 507 | 140 | 138 | 117 | 120 | 160 | 157 | 140 | 3xM10 | 62        | 56  |
| (m)PML1 80/140 | 1,1         | 450          | 536 | 140 | 138 | 117 | 120 | 160 | 180 | 140 | 3xM10 | 70        | 63  |
| (m)PML1 80/150 | 1,1         | 450          | 536 | 140 | 138 | 117 | 120 | 160 | 180 | 140 | 3xM10 | 70        | 64  |
| (m)PML1 80/160 | 1,5         | 450          | 590 | 140 | 138 | 117 | 135 | 200 | 180 | 140 | 3xM10 | 91        | 62  |
| (m)PML1 80/170 | 1,5         | 450          | 590 | 135 | 155 | 137 | 135 | 200 | 180 | 140 | 3xM10 | 99        | 82  |
| (m)PML1 80/180 | 1,5         | 450          | 590 | 135 | 155 | 137 | 135 | 200 | 180 | 140 | 3xM10 | 92        | 83  |
| (m)PML1 80/190 | 2,2         | 450          | 601 | 135 | 155 | 137 | 154 | 250 | 206 | 140 | 3xM10 | 95        | 86  |
| (m)PML1 80/200 | 2,2         | 450          | 601 | 135 | 155 | 137 | 154 | 250 | 206 | 140 | 3xM10 | 103       | 94  |

DANE ELEKTRYCZNE

| Moc silnika [kW] | Wielkość wałka | U [V]             | n [min <sup>-1</sup> ] | η [%] | cos φ | In [A]    | In/Ir [A] |
|------------------|----------------|-------------------|------------------------|-------|-------|-----------|-----------|
| 0,75             | W2             | 3~230-240/400-415 | 1400                   | 80    | 0,65  | 3,70/2,20 | 4,2       |
| 1,1              | W3             | 3~230-240/400-415 | 1400                   | 81    | 0,76  | 4,50/2,60 | 5,7       |
| 1,5              | W3             | 3~400-415         | 1400                   | 83    | 0,76  | 3,40      | 6,0       |
| 2,2              | W4             | 3~400-415         | 1400                   | 85    | 0,83  | 4,50      | 7,3       |



## POMPY LINIOWE

### CHARAKTERYSTYKA

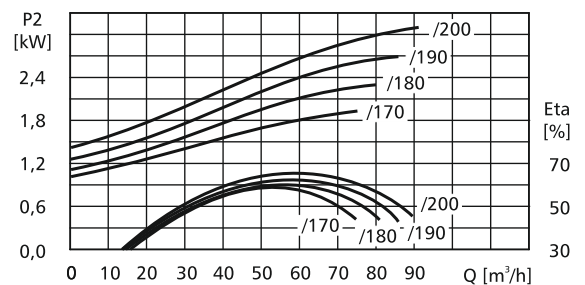
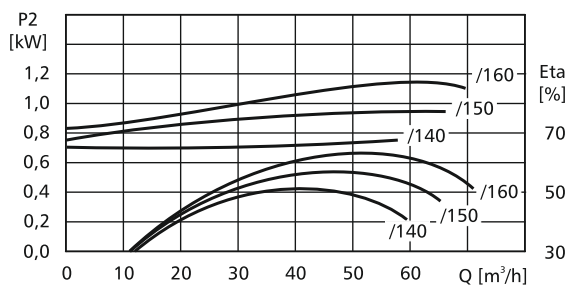
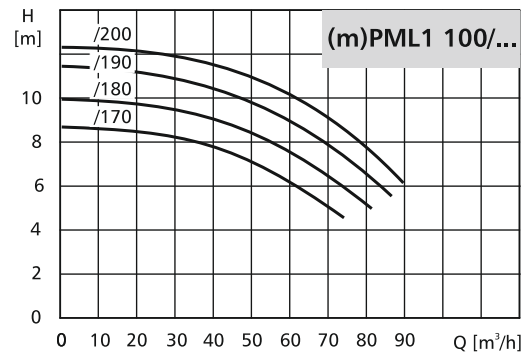
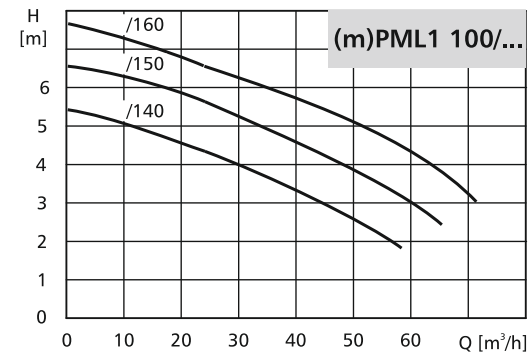

### DANE MONTAŻOWE

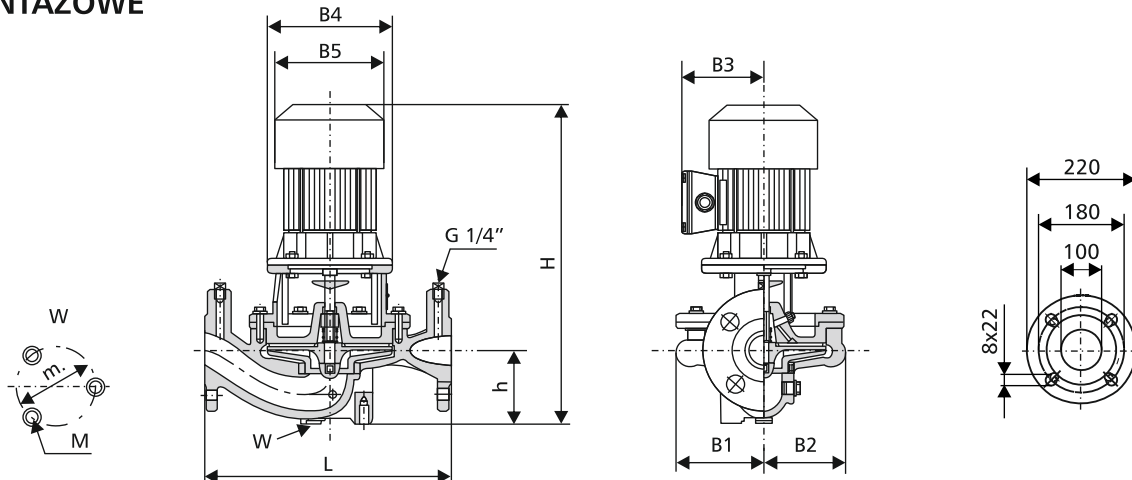

| TYP POMPY       | Moc silnika | Wymiary [mm] |     |     |     |     |     |     |     |     |       | Masa [kg] |     |
|-----------------|-------------|--------------|-----|-----|-----|-----|-----|-----|-----|-----|-------|-----------|-----|
|                 |             | L            | H   | h   | B1  | B2  | B3  | B4  | B5  | m   | M     | mPML      | PML |
| (m)PML1 100/140 | 1,1         | 500          | 566 | 165 | 161 | 133 | 120 | 160 | 180 | 140 | 3xM10 | 78        | 71  |
| (m)PML1 100/150 | 1,1         | 500          | 566 | 165 | 161 | 133 | 120 | 160 | 180 | 140 | 3xM10 | 79        | 72  |
| (m)PML1 100/160 | 1,5         | 500          | 611 | 165 | 161 | 133 | 135 | 200 | 180 | 140 | 3xM10 | 80        | 73  |
| (m)PML1 100/170 | 2,2         | 500          | 648 | 155 | 171 | 147 | 154 | 250 | 206 | 140 | 3xM10 | 85        | 77  |
| (m)PML1 100/180 | 2,2         | 500          | 648 | 155 | 171 | 147 | 154 | 250 | 206 | 140 | 3xM10 | 85        | 78  |
| (m)PML1 100/190 | 3,0         | 500          | 648 | 155 | 171 | 147 | 154 | 250 | 206 | 140 | 3xM10 | 91        | 83  |
| (m)PML1 100/200 | 3,0         | 500          | 648 | 155 | 171 | 147 | 154 | 250 | 206 | 140 | 3xM10 | 92        | 84  |

### DANE ELEKTRYCZNE

| Moc silnika [kW] | Wielkość wałki | U [V]             | n [min <sup>-1</sup> ] | $\eta$ [%] | cos $\varphi$ | I <sub>n</sub> [A] | I <sub>n</sub> /I <sub>r</sub> [A] |
|------------------|----------------|-------------------|------------------------|------------|---------------|--------------------|------------------------------------|
| 1,1              | W3             | 3~230-240/400-415 | 1400                   | 81         | 0,76          | 4,50/2,60          | 5,7                                |
| 1,5              | W3             | 3~400-415         | 1400                   | 83         | 0,76          | 3,40               | 6,0                                |
| 2,2              | W4             | 3~400-415         | 1400                   | 85         | 0,83          | 4,50               | 7,3                                |
| 3,0              | W4             | 3~400-415         | 1400                   | 86         | 0,75          | 6,80               | 7,0                                |

CHARAKTERYSTYKA

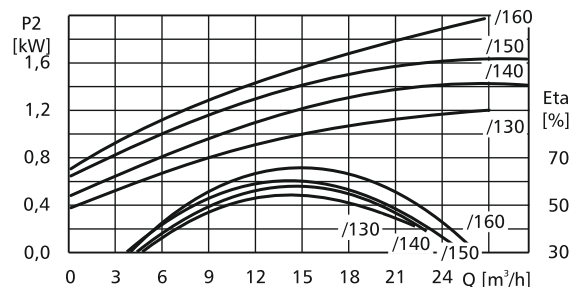
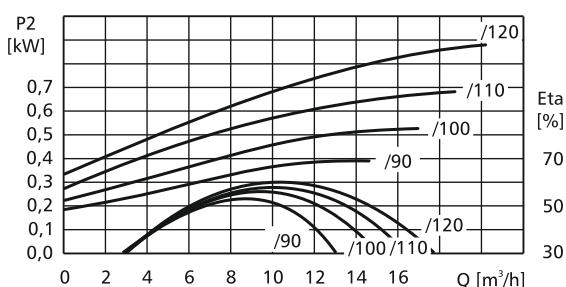
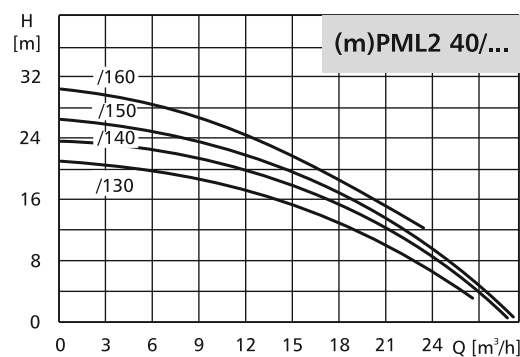
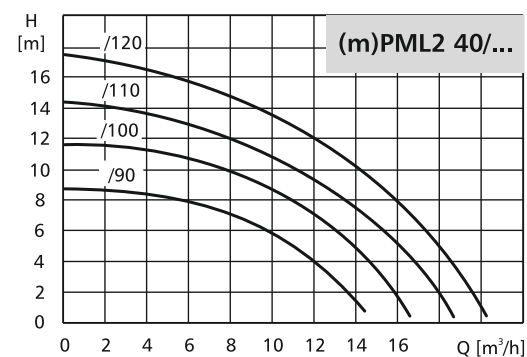

DANE MONTAŻOWE

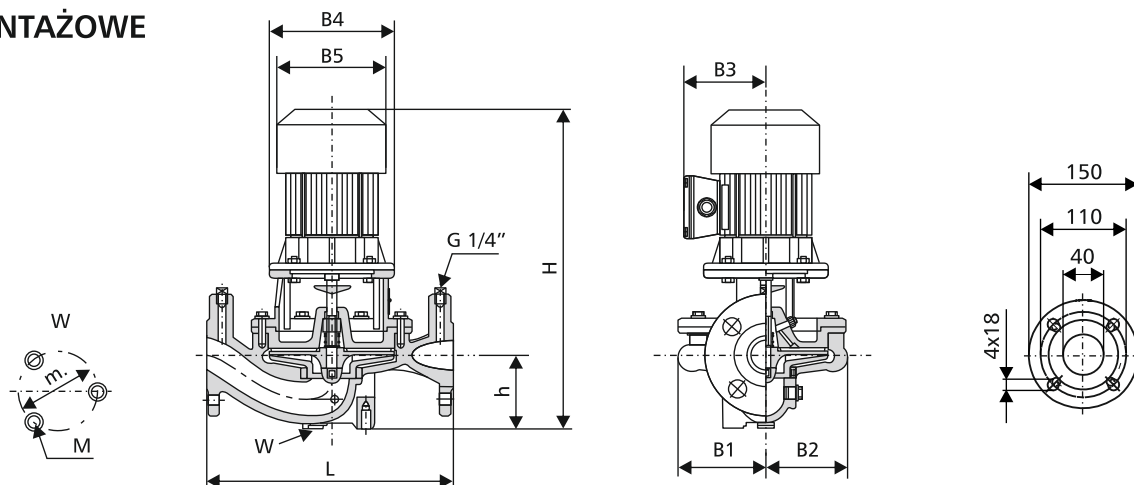

| TYP POMPY      | Moc silnika | Wymiary [mm] |     |    |     |     |     |     |     |    |       | Masa [kg] |     |
|----------------|-------------|--------------|-----|----|-----|-----|-----|-----|-----|----|-------|-----------|-----|
|                |             | L            | H   | h  | B1  | B2  | B3  | B4  | B5  | m  | M     | mPML      | PML |
| (m)PML2 40/90  | 0,37        | 250          | 387 | 80 | 81  | 79  | 107 | 160 | 141 | 90 | 3xM10 | 17        | 15  |
| (m)PML2 40/100 | 0,55        | 250          | 396 | 80 | 81  | 79  | 107 | 160 | 141 | 90 | 3xM10 | 17        | 15  |
| (m)PML2 40/110 | 0,75        | 250          | 412 | 80 | 81  | 79  | 120 | 160 | 157 | 90 | 3xM10 | 20        | 18  |
| (m)PML2 40/120 | 1,1         | 250          | 429 | 80 | 81  | 79  | 120 | 160 | 157 | 90 | 3xM10 | 27        | 24  |
| (m)PML2 40/130 | 1,1         | 320          | 439 | 90 | 103 | 102 | 120 | 160 | 157 | 90 | 3xM10 | 31        | 28  |
| (m)PML2 40/140 | 1,5         | 320          | 496 | 90 | 103 | 102 | 135 | 200 | 180 | 90 | 3xM10 | 34        | 31  |
| (m)PML2 40/150 | 1,5         | 320          | 496 | 90 | 103 | 102 | 135 | 200 | 180 | 90 | 3xM10 | 34        | 31  |
| (m)PML2 40/160 | 2,2         | 320          | 496 | 90 | 103 | 102 | 135 | 200 | 180 | 90 | 3xM10 | 45        | 41  |

DANE ELEKTRYCZNE

| Moc silnika [kW] | Wielkość węża | U [V]             | n [min <sup>-1</sup> ] | $\eta$ [%] | cos $\varphi$ | $I_n$ [A] | $I_n/I_r$ [A] |
|------------------|---------------|-------------------|------------------------|------------|---------------|-----------|---------------|
| 0,37             | W1            | 3~230-240/400-415 | 2900                   | 71         | 0,77          | 1,73/1,00 | 4,4           |
| 0,55             | W1            | 3~230-240/400-415 | 2900                   | 75         | 0,82          | 2,35/1,35 | 4,0           |
| 0,75             | W1            | 3~230-240/400-415 | 2900                   | 79         | 0,74          | 3,30/1,90 | 5,0           |
| 1,1              | W1            | 3~230-240/400-415 | 2900                   | 80         | 0,75          | 4,80/2,70 | 5,5           |
| 1,5              | W2            | 3~400-415         | 2900                   | 82         | 0,81          | 3,30      | 7,6           |
| 2,2              | W2            | 3~400-415         | 2900                   | 83         | 0,81          | 4,70      | 7,3           |

## POMPY LINIOWE

### CHARAKTERYSTYKA

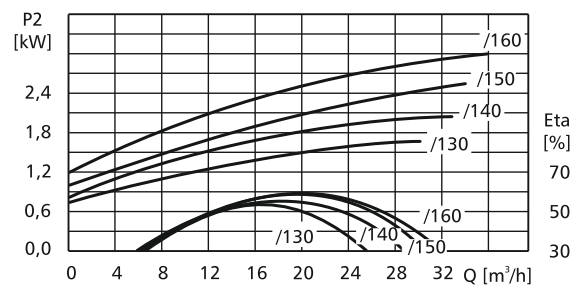
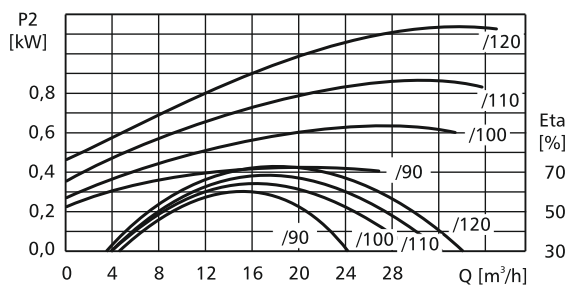
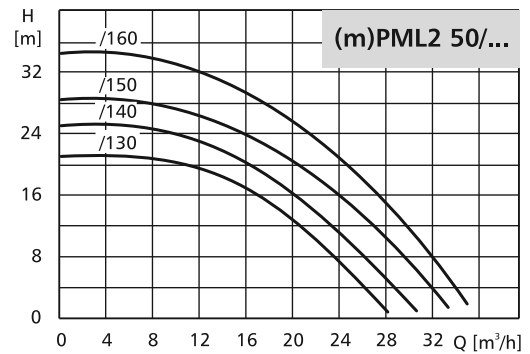
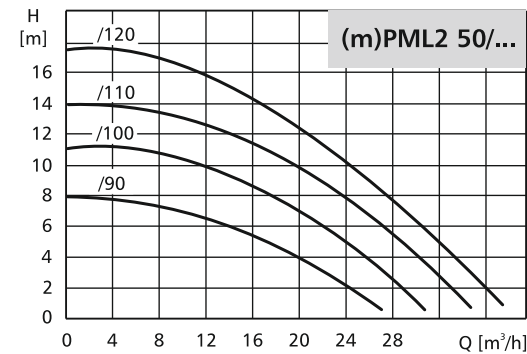

### DANE MONTAŻOWE

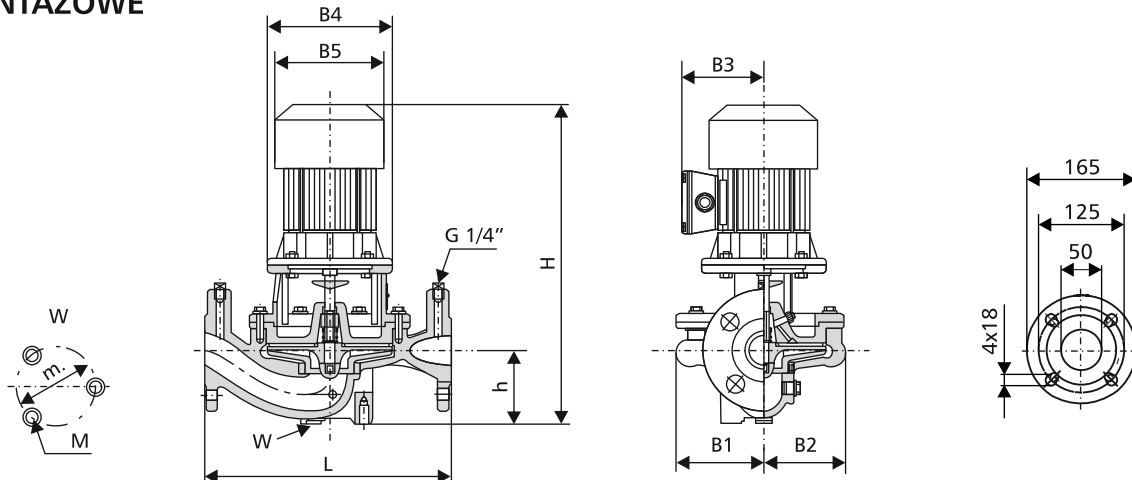

| TYP POMPY      | Moc silnika | Wymiary [mm] |     |     |     |     |     |     |     |    |       | Masa [kg] |     |
|----------------|-------------|--------------|-----|-----|-----|-----|-----|-----|-----|----|-------|-----------|-----|
|                |             | L            | H   | h   | B1  | B2  | B3  | B4  | B5  | m  | M     | mPML      | PML |
| (m)PML2 50/90  | 0,55        | 280          | 415 | 95  | 102 | 102 | 107 | 160 | 141 | 90 | 3xM10 | 24        | 22  |
| (m)PML2 50/100 | 0,75        | 280          | 431 | 95  | 102 | 102 | 120 | 160 | 157 | 90 | 3xM10 | 27        | 24  |
| (m)PML2 50/110 | 1,1         | 280          | 443 | 95  | 102 | 102 | 120 | 160 | 157 | 90 | 3xM10 | 28        | 26  |
| (m)PML2 50/120 | 1,1         | 280          | 443 | 95  | 102 | 102 | 120 | 160 | 157 | 90 | 3xM10 | 28        | 26  |
| (m)PML2 50/130 | 1,5         | 340          | 523 | 105 | 105 | 102 | 135 | 200 | 180 | 90 | 3xM10 | 43        | 39  |
| (m)PML2 50/140 | 2,2         | 340          | 523 | 105 | 105 | 102 | 135 | 200 | 180 | 90 | 3xM10 | 47        | 43  |
| (m)PML2 50/150 | 2,2         | 340          | 523 | 105 | 105 | 102 | 135 | 200 | 180 | 90 | 3xM10 | 47        | 43  |
| (m)PML2 50/160 | 3,0         | 340          | 560 | 105 | 105 | 102 | 154 | 250 | 206 | 90 | 3xM10 | 49        | 44  |

### DANE ELEKTRYCZNE

| Moc silnika [kW] | Wielkość wałki | U [V]             | n [min <sup>-1</sup> ] | $\eta$ [%] | cos $\varphi$ | $I_n$ [A] | $I_n/I_r$ [A] |
|------------------|----------------|-------------------|------------------------|------------|---------------|-----------|---------------|
| 0,55             | W1             | 3~230-240/400-415 | 2900                   | 75         | 0,82          | 2,35/1,35 | 4,0           |
| 0,75             | W1             | 3~230-240/400-415 | 2900                   | 79         | 0,74          | 3,30/1,90 | 5,0           |
| 1,1              | W1             | 3~230-240/400-415 | 2900                   | 80         | 0,75          | 4,80/2,70 | 5,5           |
| 1,5              | W2             | 3~400-415         | 2900                   | 82         | 0,81          | 3,30      | 7,6           |
| 2,2              | W2             | 3~400-415         | 2900                   | 83         | 0,81          | 4,70      | 7,3           |
| 3,0              | W2             | 3~400-415         | 2900                   | 85         | 0,83          | 6,20      | 8,3           |

CHARAKTERYSTYKA

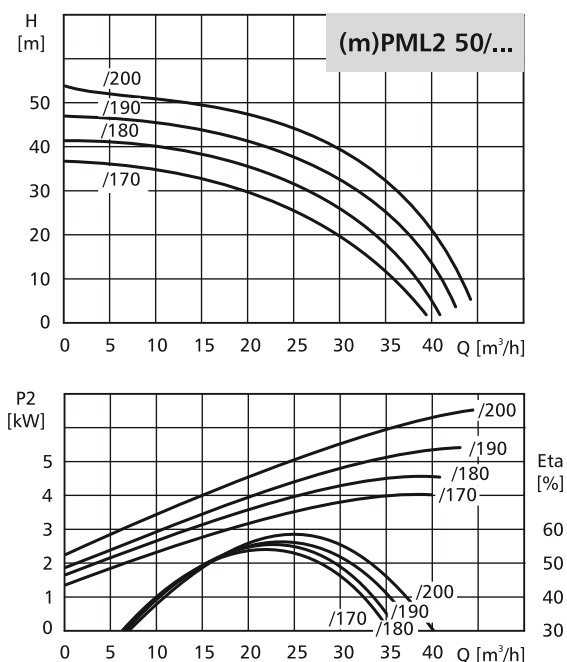

DANE MONTAŻOWE

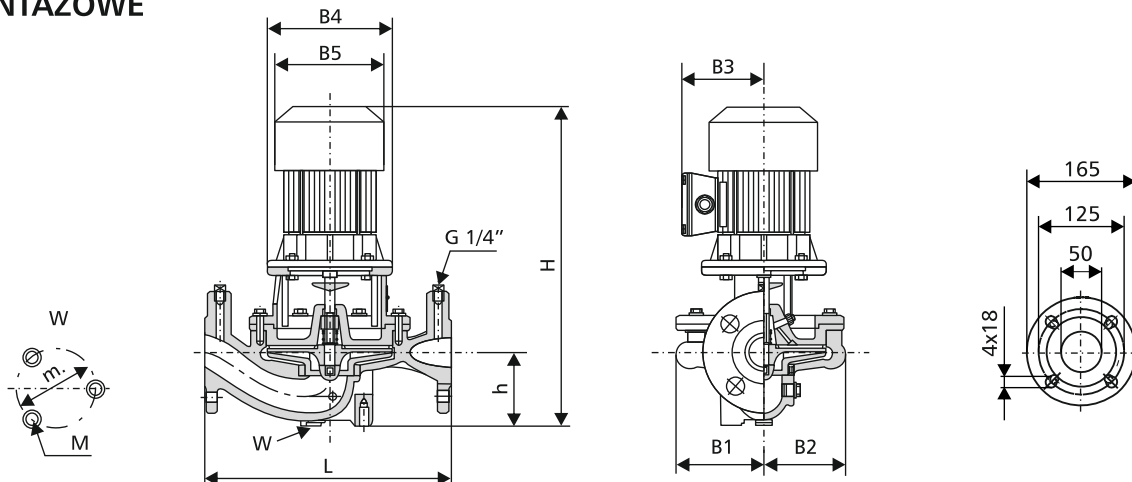

| TYP POMPY      | Moc silnika | Wymiary [mm] |     |     |     |     |     |     |     |     |       | Masa [kg] |     |
|----------------|-------------|--------------|-----|-----|-----|-----|-----|-----|-----|-----|-------|-----------|-----|
|                |             | L            | H   | h   | B1  | B2  | B3  | B4  | B5  | m   | M     | mPML      | PML |
| (m)PML2 50/170 | 4,0         | 400          | 576 | 110 | 122 | 122 | 167 | 250 | 233 | 140 | 3xM10 | 68        | 62  |
| (m)PML2 50/180 | 5,5         | 400          | 598 | 110 | 122 | 122 | 216 | 300 | 261 | 140 | 3xM10 | 103       | 95  |
| (m)PML2 50/190 | 5,5         | 400          | 598 | 110 | 122 | 122 | 216 | 300 | 261 | 140 | 3xM10 | 103       | 95  |
| (m)PML2 50/200 | 5,5         | 400          | 598 | 110 | 122 | 122 | 216 | 300 | 261 | 140 | 3xM10 | 103       | 95  |

DANE ELEKTRYCZNE

| Moc silnika [kW] | Wielkość wiatka | U [V]             | n [min <sup>-1</sup> ] | η [%] | cos φ | In [A]     | In/Ir [A] |
|------------------|-----------------|-------------------|------------------------|-------|-------|------------|-----------|
| 4,0              | W3              | 3~400-415         | 2900                   | 86    | 0,87  | 7,70       | 8,5       |
| 5,5              | W3              | 3~400-415/660-690 | 2900                   | 87    | 0,90  | 10,10/5,80 | 8,8       |

## POMPY LINIOWE

### CHARAKTERYSTYKA

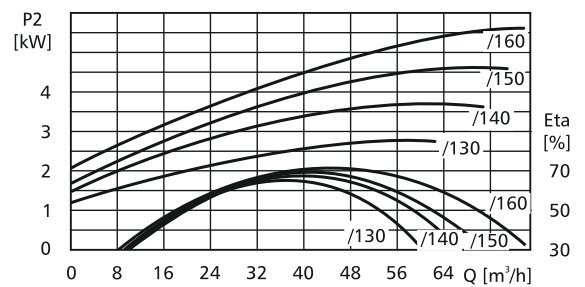
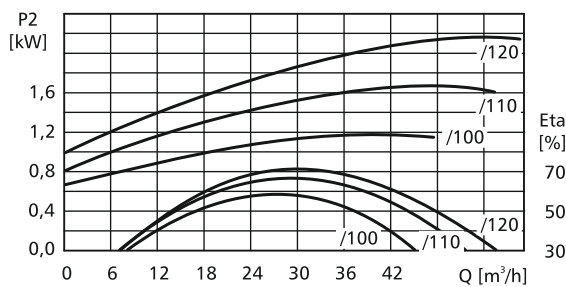
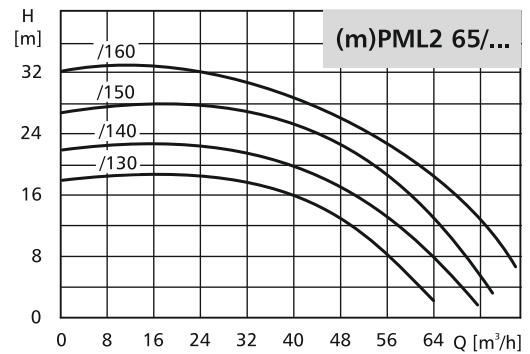
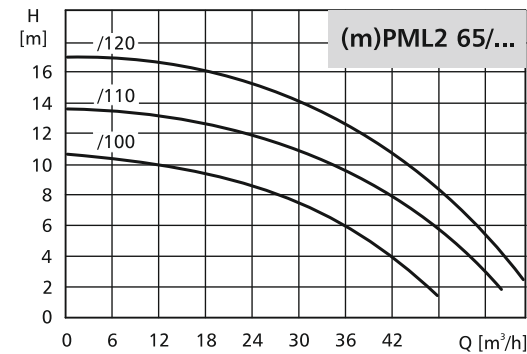

### DANE MONTAŻOWE

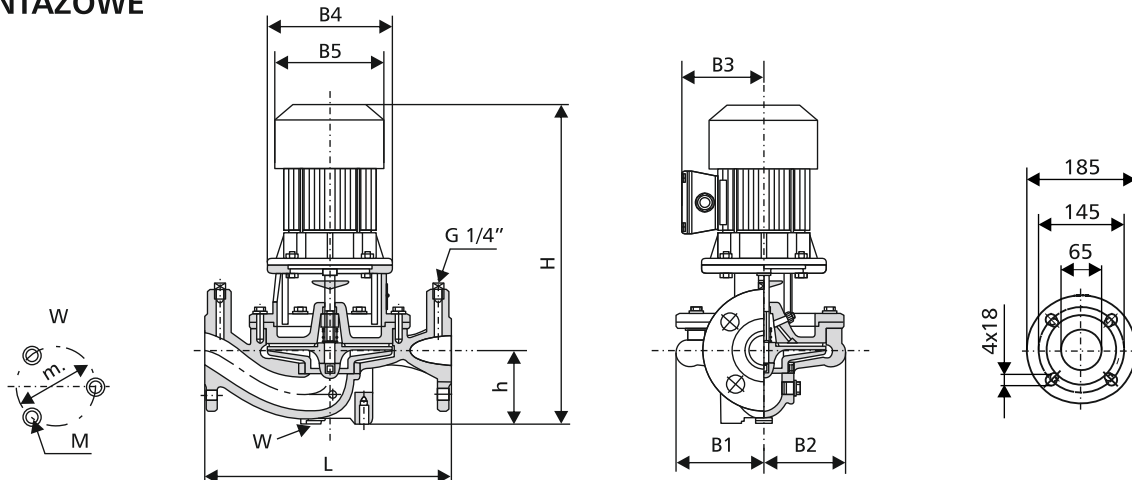

| TYP POMPY      | Moc silnika | Wymiary [mm] |     |     |     |     |     |     |     |    |       | Masa [kg] |     |
|----------------|-------------|--------------|-----|-----|-----|-----|-----|-----|-----|----|-------|-----------|-----|
|                |             | L            | H   | h   | B1  | B2  | B3  | B4  | B5  | m  | M     | mPML      | PML |
| (m)PML2 65/100 | 1,1         | 340          | 468 | 115 | 94  | 90  | 120 | 160 | 157 | 90 | 3xM10 | 32        | 29  |
| (m)PML2 65/110 | 1,5         | 340          | 541 | 115 | 94  | 90  | 135 | 200 | 180 | 90 | 3xM10 | 40        | 38  |
| (m)PML2 65/120 | 2,2         | 340          | 566 | 115 | 94  | 90  | 135 | 200 | 180 | 90 | 3xM10 | 44        | 40  |
| (m)PML2 65/130 | 3,0         | 400          | 559 | 120 | 124 | 109 | 154 | 250 | 206 | 90 | 3xM10 | 45        | 54  |
| (m)PML2 65/140 | 4,0         | 400          | 573 | 120 | 124 | 109 | 167 | 250 | 233 | 90 | 3xM10 | 63        | 64  |
| (m)PML2 65/150 | 5,5         | 400          | 628 | 120 | 124 | 109 | 216 | 300 | 261 | 90 | 3xM10 | 107       | 99  |
| (m)PML2 65/160 | 5,5         | 400          | 628 | 120 | 124 | 109 | 216 | 300 | 261 | 90 | 3xM10 | 107       | 99  |

### DANE ELEKTRYCZNE

| Moc silnika [kW] | Wielkość wałki | U [V]             | n [min <sup>-1</sup> ] | $\eta$ [%] | cos $\varphi$ | I <sub>n</sub> [A] | I <sub>n</sub> /I <sub>r</sub> [A] |
|------------------|----------------|-------------------|------------------------|------------|---------------|--------------------|------------------------------------|
| 1,1              | W1             | 3~230-240/400-415 | 2900                   | 80         | 0,75          | 4,80/2,70          | 5,5                                |
| 1,5              | W2             | 3~400-415         | 2900                   | 82         | 0,81          | 3,30               | 7,6                                |
| 2,2              | W2             | 3~400-415         | 2900                   | 83         | 0,81          | 4,70               | 7,3                                |
| 3,0              | W2             | 3~400-415         | 2900                   | 85         | 0,83          | 6,20               | 8,3                                |
| 4,0              | W3             | 3~400-415         | 2900                   | 86         | 0,87          | 7,70               | 8,5                                |
| 5,5              | W3             | 3~400-415/660-690 | 2900                   | 87         | 0,90          | 10,10/5,80         | 8,8                                |

CHARAKTERYSTYKA

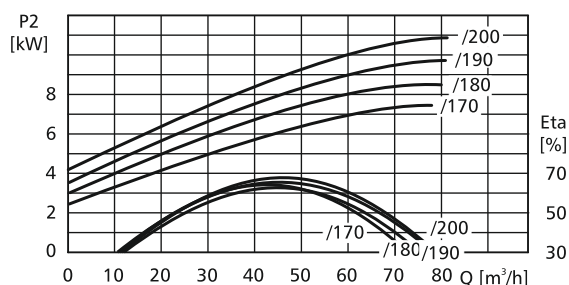
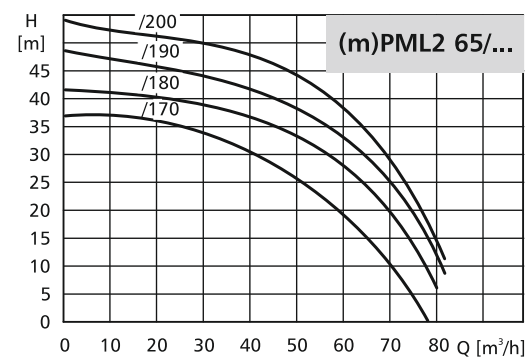

DANE MONTAŻOWE

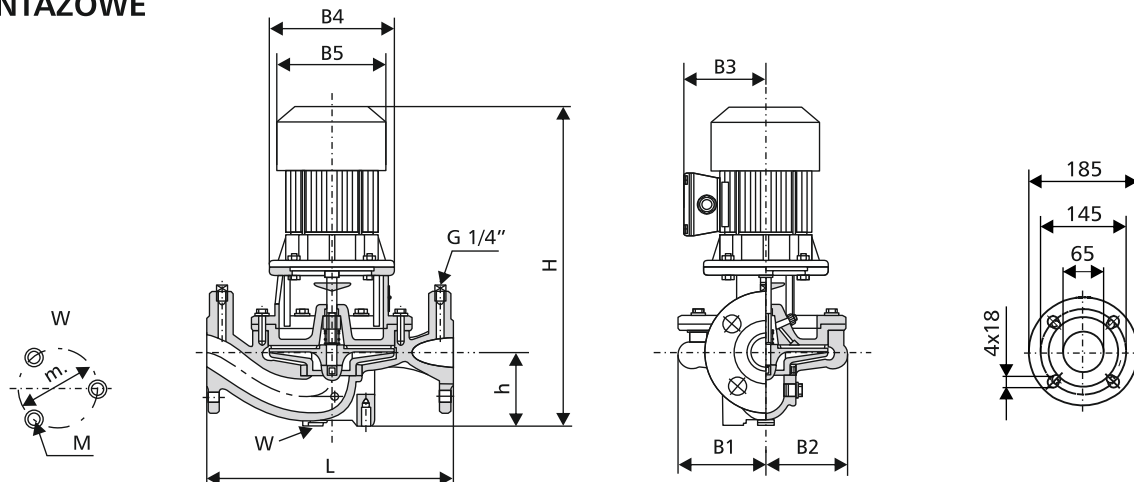

| TYP POMPY      | Moc silnika | Wymiary [mm] |     |     |     |     |     |     |     |     |       | Masa [kg] |     |
|----------------|-------------|--------------|-----|-----|-----|-----|-----|-----|-----|-----|-------|-----------|-----|
|                |             | L            | H   | h   | B1  | B2  | B3  | B4  | B5  | m   | M     | mPML      | PML |
| (m)PML2 65/170 | 7,5         | 400          | 646 | 110 | 139 | 126 | 216 | 300 | 261 | 140 | 3xM10 | 128       | 109 |
| (m)PML2 65/180 | 11          | 400          | 797 | 110 | 139 | 126 | 210 | 350 | 323 | 140 | 3xM10 | 150       | 136 |
| (m)PML2 65/190 | 11          | 400          | 797 | 110 | 139 | 126 | 210 | 350 | 323 | 140 | 3xM10 | 150       | 136 |
| (m)PML2 65/200 | 11          | 400          | 797 | 110 | 139 | 126 | 210 | 350 | 323 | 140 | 3xM10 | 154       | 136 |

DANE ELEKTRYCZNE

| Moc silnika [kW] | Wielkość wałki | U [V]             | n [min <sup>-1</sup> ] | η [%] | cos φ | In [A]      | In/Ir [A] |
|------------------|----------------|-------------------|------------------------|-------|-------|-------------|-----------|
| 7,5              | W3             | 3~400-415/660-690 | 2900                   | 89    | 0,92  | 13,20/7,70  | 8,5       |
| 11               | W4             | 3~400-415/660-690 | 2900                   | 90    | 0,87  | 20,30/11,80 | 7,2       |

### POMPY LINIOWE

#### CHARAKTERYSTYKA

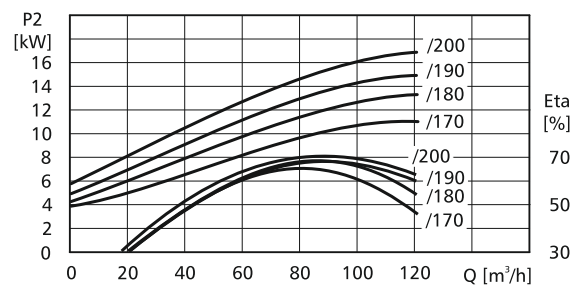
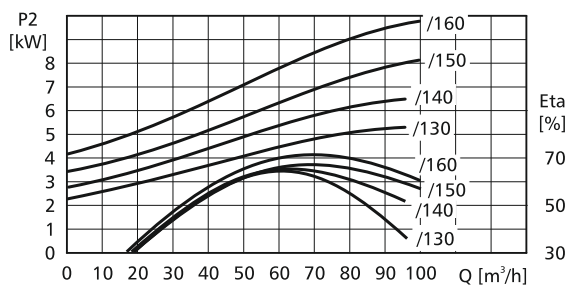
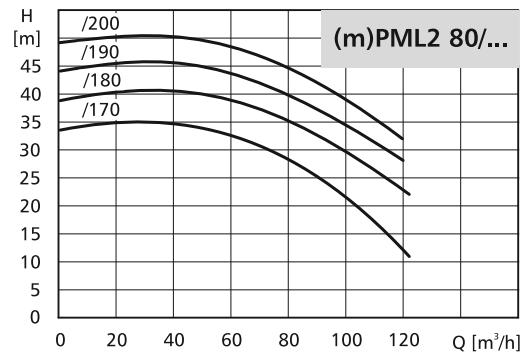
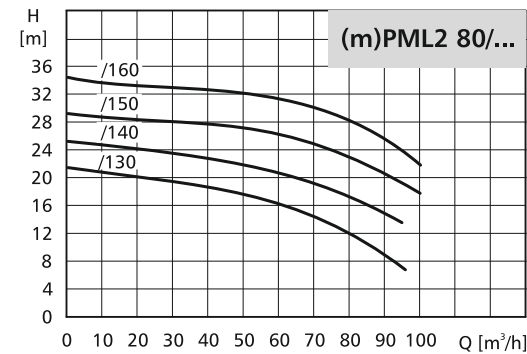

#### DANE MONTAŻOWE

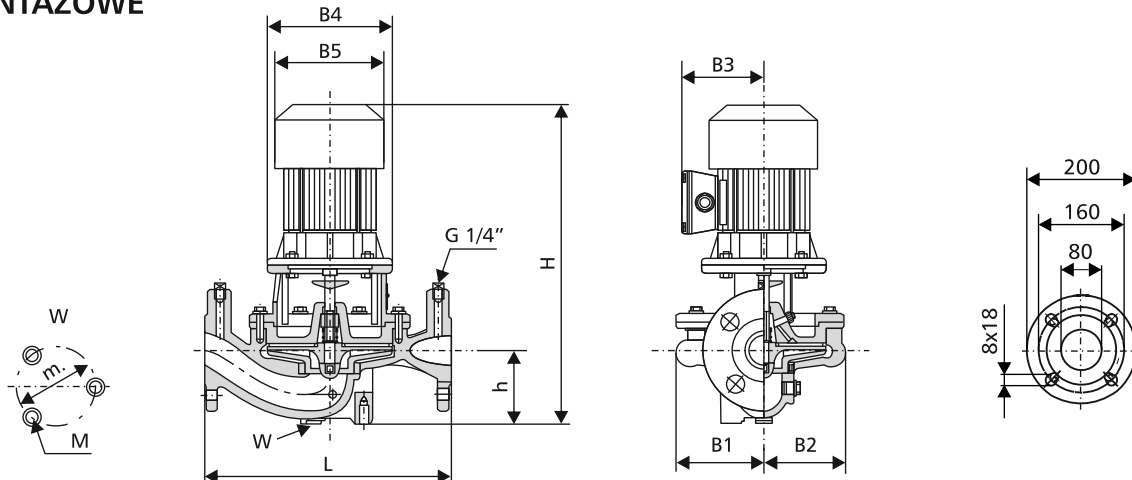

| TYP POMPY      | Moc silnika | Wymiary [mm] |     |     |     |     |     |     |     |     |       | Masa [kg] |     |
|----------------|-------------|--------------|-----|-----|-----|-----|-----|-----|-----|-----|-------|-----------|-----|
|                |             | L            | H   | h   | B1  | B2  | B3  | B4  | B5  | m   | M     | mPML      | PML |
| (m)PML2 80/130 | 5,5         | 450          | 635 | 140 | 138 | 117 | 216 | 300 | 261 | 140 | 3xM10 | 134       | 123 |
| (m)PML2 80/140 | 7,5         | 450          | 635 | 140 | 138 | 117 | 216 | 300 | 261 | 140 | 3xM10 | 141       | 129 |
| (m)PML2 80/150 | 7,5         | 450          | 635 | 140 | 138 | 117 | 216 | 300 | 261 | 140 | 3xM10 | 141       | 129 |
| (m)PML2 80/160 | 11          | 450          | 806 | 140 | 138 | 117 | 210 | 350 | 323 | 140 | 3xM10 | 175       | 159 |
| (m)PML2 80/170 | 11          | 450          | 830 | 135 | 155 | 137 | 210 | 350 | 323 | 140 | 3xM10 | 175       | 164 |
| (m)PML2 80/180 | 11          | 450          | 830 | 135 | 155 | 137 | 210 | 350 | 323 | 140 | 3xM10 | 182       | 165 |
| (m)PML2 80/190 | 15          | 450          | 830 | 135 | 155 | 137 | 210 | 350 | 323 | 140 | 3xM10 | 187       | 168 |
| (m)PML2 80/200 | 15          | 450          | 830 | 135 | 155 | 137 | 210 | 350 | 323 | 140 | 3xM10 | 189       | 170 |

#### DANE ELEKTRYCZNE

| Moc silnika [kW] | Wielkość wałka | U [V]             | n [min <sup>-1</sup> ] | $\eta$ [%] | cos $\varphi$ | I <sub>n</sub> [A] | I <sub>n</sub> /I <sub>r</sub> [A] |
|------------------|----------------|-------------------|------------------------|------------|---------------|--------------------|------------------------------------|
| 5,5              | W3             | 3~400-415/660-690 | 2900                   | 87         | 0,90          | 10,10/5,80         | 8,8                                |
| 7,5              | W3             | 3~400-415/660-690 | 2900                   | 89         | 0,92          | 13,20/7,70         | 8,5                                |
| 11               | W4             | 3~400-415/660-690 | 2900                   | 90         | 0,87          | 20,30/11,80        | 7,2                                |
| 15               | W4             | 3~400-415/660-690 | 2900                   | 90         | 0,89          | 26,90/15,60        | 7,0                                |

CHARAKTERYSTYKA

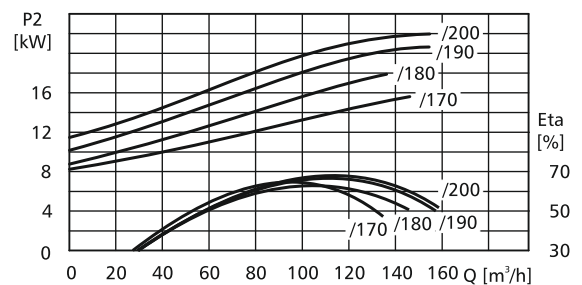
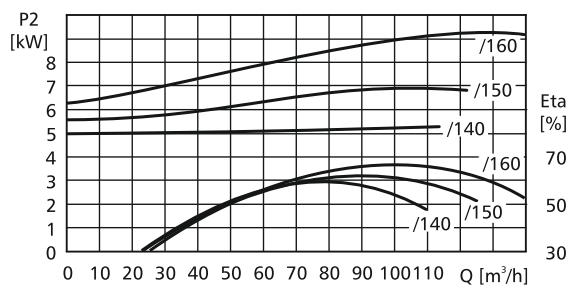
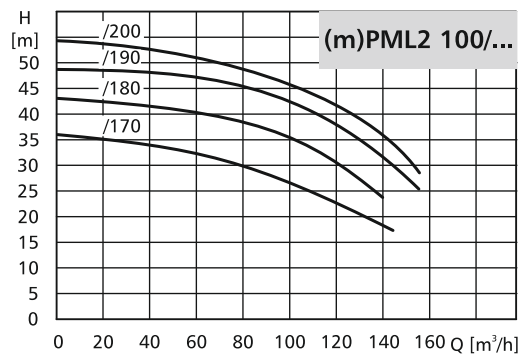
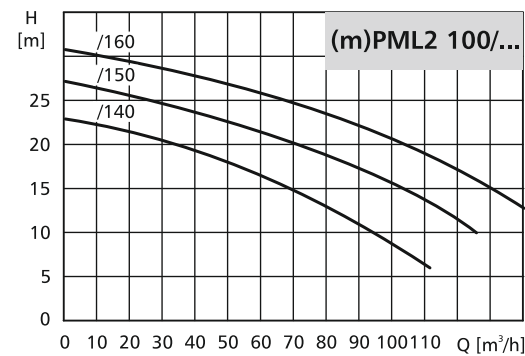

DANE MONTAŻOWE

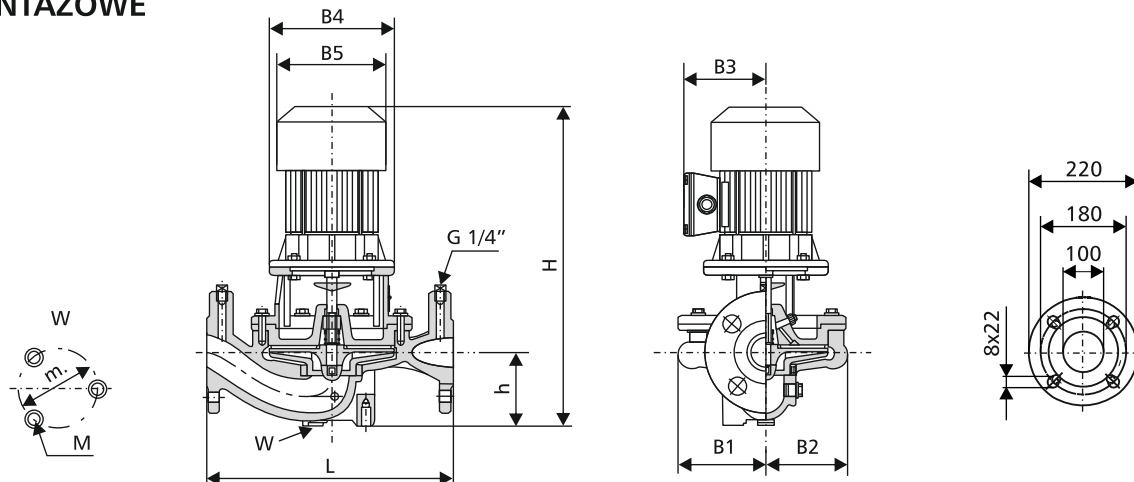

| TYP POMPY       | Moc silnika | Wymiary [mm] |     |     |     |     |     |     |     |     |       | Masa [kg] |     |
|-----------------|-------------|--------------|-----|-----|-----|-----|-----|-----|-----|-----|-------|-----------|-----|
|                 |             | L            | H   | h   | B1  | B2  | B3  | B4  | B5  | m   | M     | mPML      | PML |
| (m)PML2 100/140 | 5,5         | 500          | 681 | 165 | 161 | 133 | 216 | 300 | 261 | 140 | 3xM10 | 141       | 130 |
| (m)PML2 100/150 | 7,5         | 500          | 681 | 165 | 161 | 133 | 216 | 300 | 261 | 140 | 3xM10 | 152       | 139 |
| (m)PML2 100/160 | 11          | 500          | 836 | 165 | 161 | 133 | 210 | 350 | 323 | 140 | 3xM10 | 186       | 168 |
| (m)PML2 100/170 | 15          | 500          | 840 | 155 | 171 | 147 | 210 | 350 | 323 | 140 | 3xM10 | 181       | 164 |
| (m)PML2 100/180 | 18,5        | 500          | 884 | 155 | 171 | 147 | 210 | 350 | 323 | 140 | 3xM10 | 199       | 179 |
| (m)PML2 100/190 | 22          | 500          | 933 | 155 | 171 | 147 | 228 | 350 | 360 | 140 | 3xM10 | 238       | 216 |
| (m)PML2 100/200 | 22          | 500          | 933 | 155 | 171 | 147 | 228 | 350 | 360 | 140 | 3xM10 | 239       | 217 |

DANE ELEKTRYCZNE

| Moc silnika [kW] | Wielkość wałki | U [V]             | n [min <sup>-1</sup> ] | $\eta$ [%] | cos $\varphi$ | $I_n$ [A]   | $I_n/I_r$ [A] |
|------------------|----------------|-------------------|------------------------|------------|---------------|-------------|---------------|
| 5,5              | W3             | 3~400-415/660-690 | 2900                   | 87         | 0,90          | 10,10/5,80  | 8,8           |
| 7,5              | W3             | 3~400-415/660-690 | 2900                   | 89         | 0,92          | 13,20/7,70  | 8,5           |
| 11               | W4             | 3~400-415/660-690 | 2900                   | 90         | 0,87          | 20,30/11,80 | 7,2           |
| 15               | W4             | 3~400-415/660-690 | 2900                   | 90         | 0,89          | 26,90/15,60 | 7,0           |
| 18,5             | W4             | 3~400-415/660-690 | 2900                   | 91         | 0,91          | 32,10/18,60 | 7,7           |
| 22               | W4             | 3~400-415/660-690 | 2900                   | 91         | 0,88          | 39,50/22,90 | 7,5           |